

## DETAILS

<b>Product Number</b>	FA11452_LN2-M2
<b>Family</b>	Leila
<b>Type</b>	Assembly
<b>Color</b>	black
<b>Diameter</b>	21,6 mm
<b>Height</b>	13,3 mm
<b>Style</b>	round
<b>Optic Material</b>	PMMA
<b>Holder Material</b>	
<b>Fastening</b>	tape
<b>Status</b>	production ready
<b>ROHS Compliant</b>	Yes
<b>Date Updated</b>	18/01/2017



## OPTICAL PROPERTIES

LED	Viewing Angle	Light Beam	Efficiency	cd/lm	Connector
MX-6	sim: 30	M2-class	-	-	-
NS6x83	29 deg	M2-class	88 %	2.820	-
OLP-x5050F6L	31 deg	M2-class	90 %	3.600	-

D

C

B

A

4

4

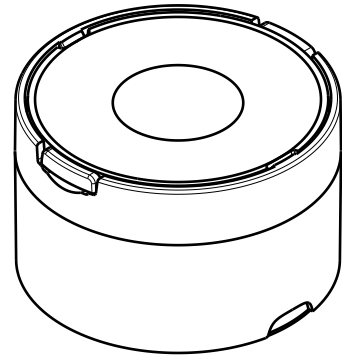
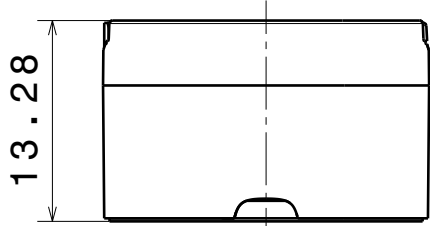

Front view

Isometric view  
Scale: 2:1

3

3

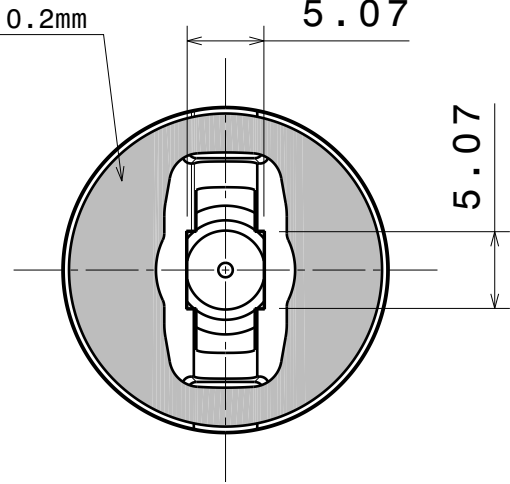
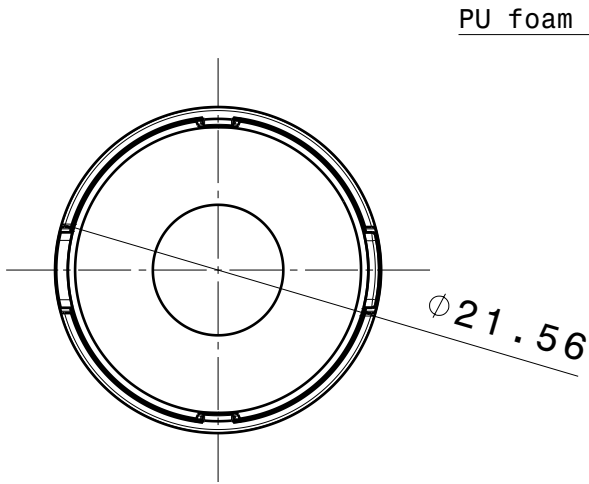

Front view  
Scale: 2:1

Rear view  
Scale: 2:1

2

2

INDEX	PART NO	DESCRIPTION	MATERIAL	COLOUR
1	F10699	LN2-LH1-TAPE	PC	black
2	-	LN2-series lens	PMMA	

Tolerances if not otherwise shown  
According to DIN ISO 2768-1  
Linear measures:  
Up to 30mm class M, otherwise class C.  
According to DIN ISO 2768-2  
Form and position: class L

**LEDiL** Ledil Oy  
Salorankatu 10  
FIN 24240 SALO  
Finland

THIRD ANGLE PROJECTION:

DRAWING TITLE  
**LN2 series**

This drawing is the property of LEDiL Oy. It may not be reproduced, copied or communicated without a written agreement with LEDiL Oy.

SIZE PART NUMBER  
**A4 -**

SCALE 2:1 WEIGHT 4 g SHEET 1/1

1

1

D

A

Luminaire: Ledil Oy FA11452\_LN2-M2 (Optogan 80lm @ 250mA) Efficiency=90%  
Lamps: 1 x Optogan 80lm @ 250mA

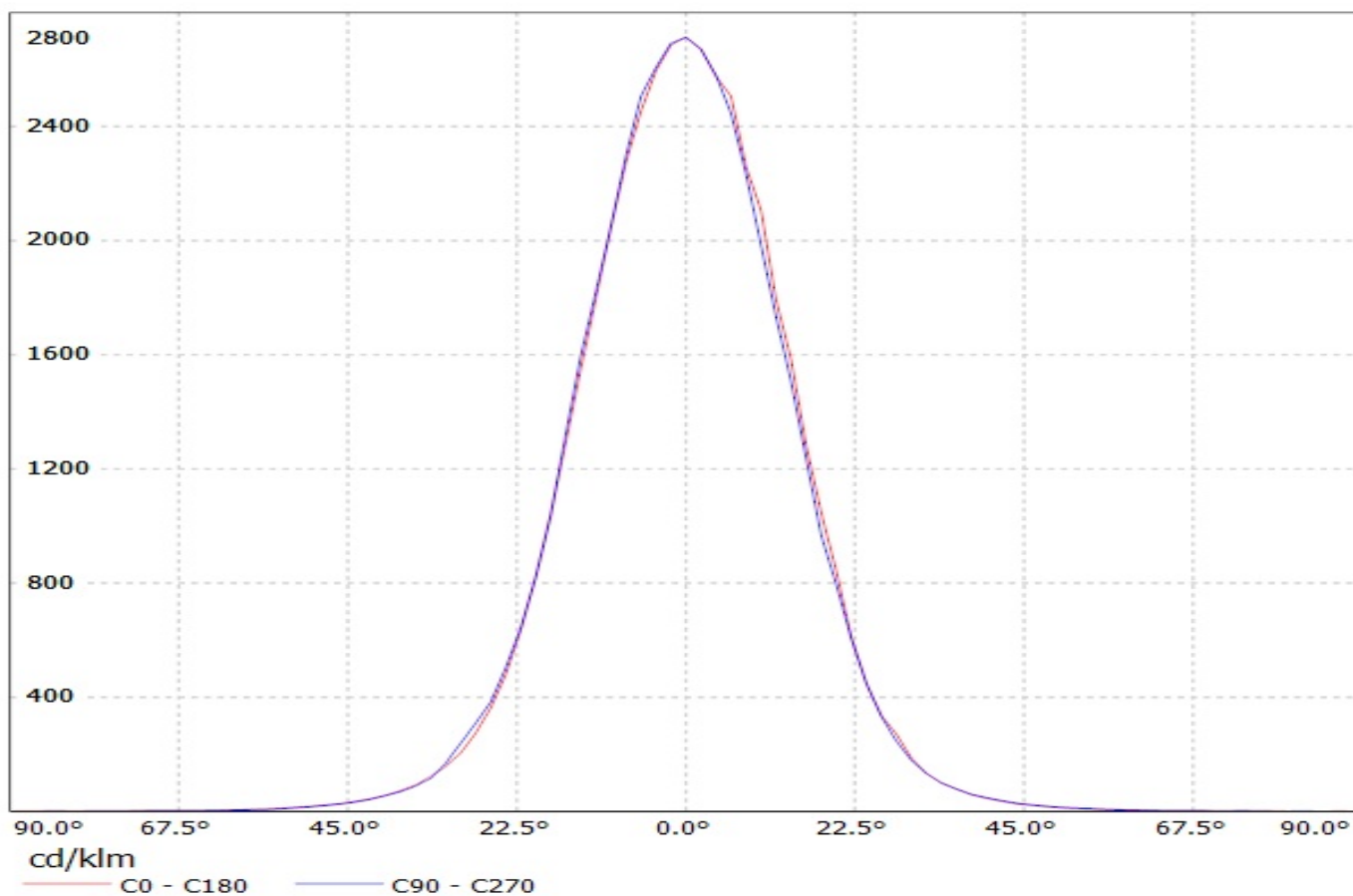

Luminaire: Ledil Oy FA11452\_LN2-M2 (Optogan 80lm @ 250mA) Efficiency=90%  
Lamps: 1 x Optogan 80lm @ 250mA

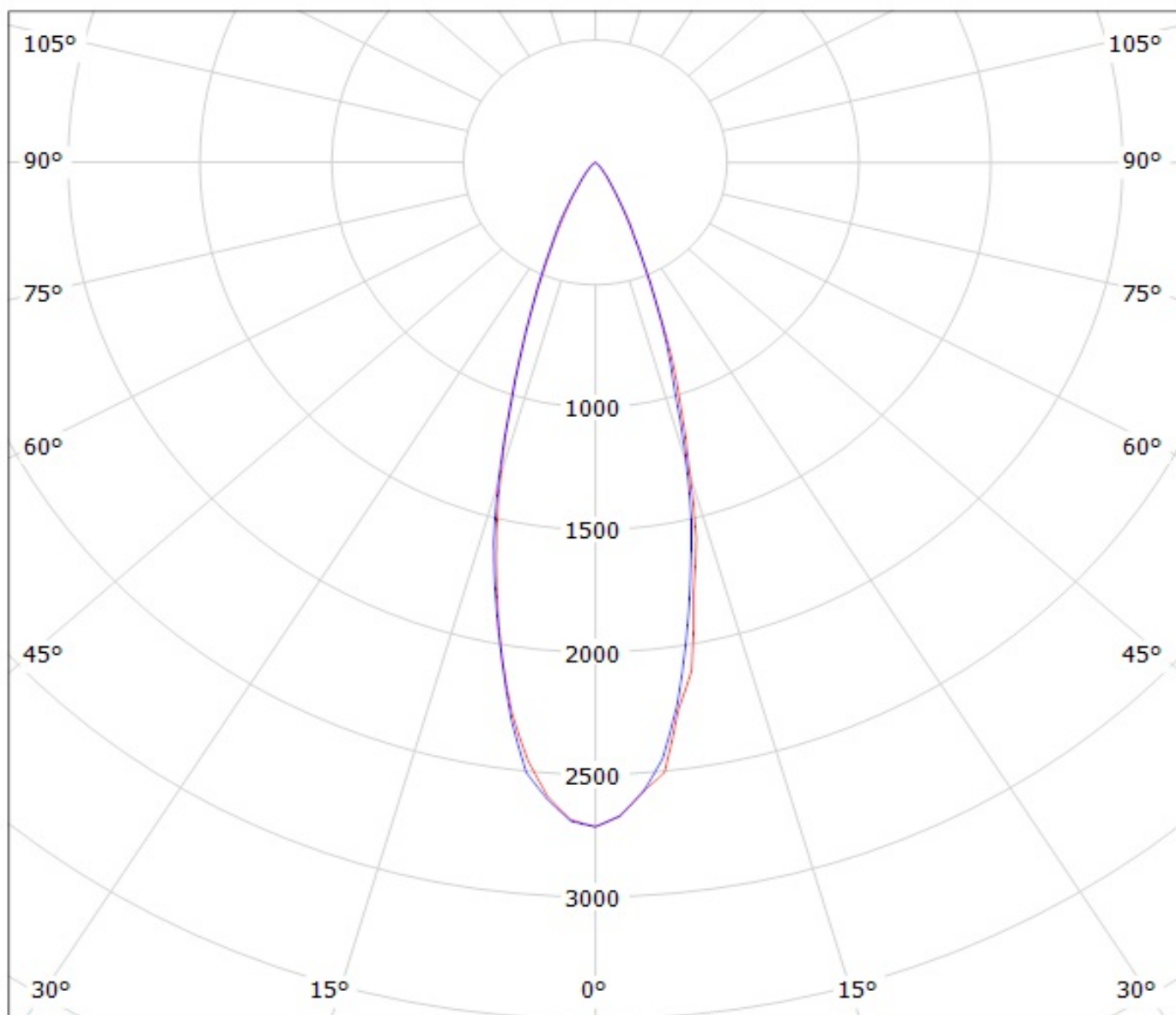

cd/klm

— C0 - C180    — C90 - C270

**NOTE: The typical divergence will be changed by different color, chip size and chip position tolerance. The typical total divergence is the full angle measured where the luminous intensity is half of the peak value.**