

8 7 6 5 4 3 2 1

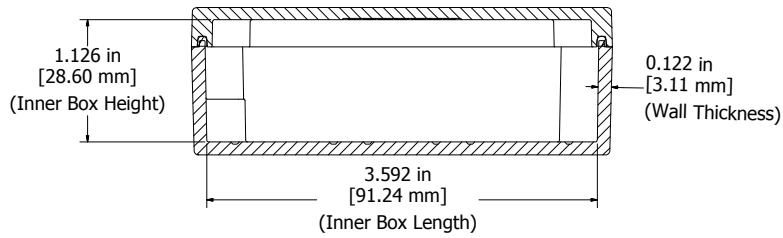

INTERNAL SHELF ACCEPTS #6 SELF TAPPING SCREW

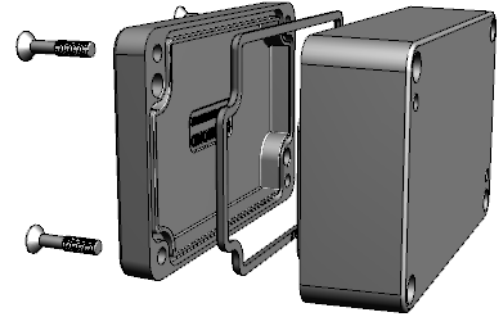
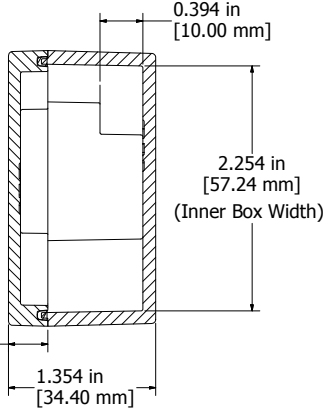
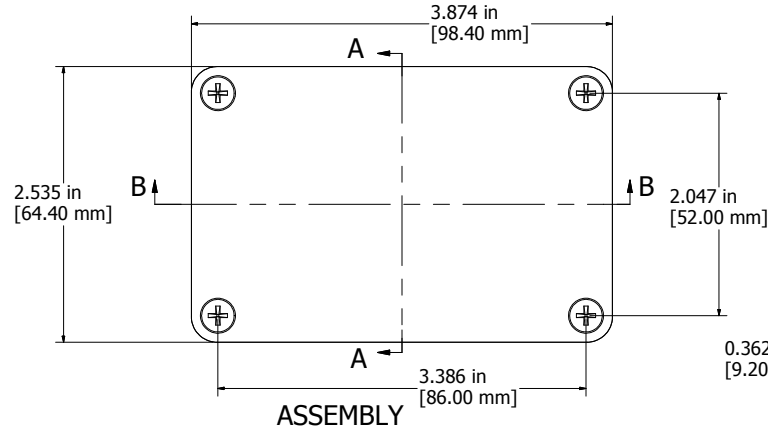
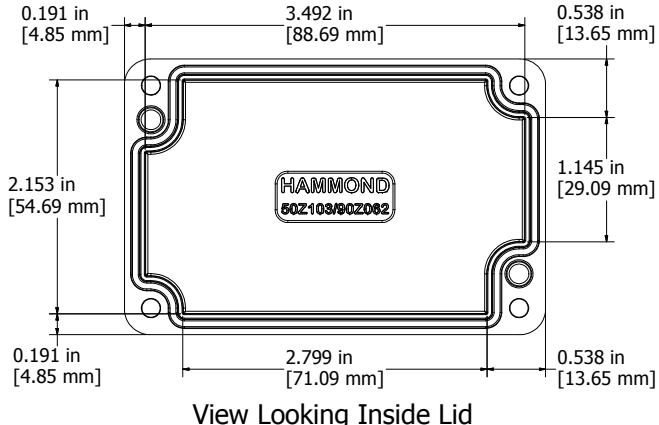
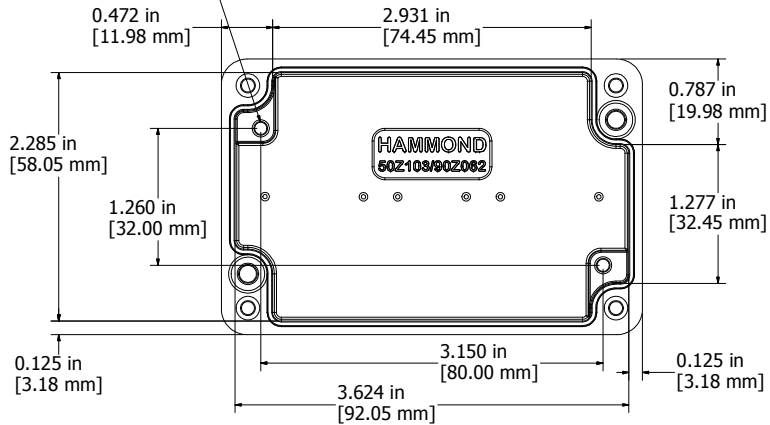

**UL** US LISTED  
File #E65324  
NEMA 4, 4X

Enclosures can be Factory Modified (Milling, Drilling, Printing etc.)  
Contact Factory [mjm@hammondmfg.com](mailto:mjm@hammondmfg.com) for quotes  
Solid models of this enclosure available in STEP or IGES.

NOTES	
Purchased assembly includes enclosure, M4x20 lid screws and #6 x 1/4 Self-Tapping screws.	
Gasket - Preformed Silicone Rubber	
Cover screws should be torqued to 5-7.5 lbf.in (50-75 cN.m)	

1590Z062	
PART NUMBERS	
Basic Enclosure	1590Z062
Black Enclosure	1590Z062BK
Grey Enclosure - RAL7001 Gloss	1590Z062GY

**HAMMOND MANUFACTURING™**  
1590Z062  
[www.hammondmfg.com](http://www.hammondmfg.com)

8 7 6 5 4 3 2 1