

A02ES-H series

High-security emergency stop switches

Distinctive features and specifications



- Approved to EN 60947-5-5, UL 508 and CSA 22.2 No 14-10
- Pull or twist to release
- AC-12, 3A 240VAC / DC-12, 2A 30V
- Panel sealed to IP65
- Built-in-safety

A02ESH1701A-R2

The A02ES-H series has been designed to ensure the highest security level. By design, this product has a failsafe modular construction.

Many other emergency stop switches are not failsafe and rely on butt action contacts: the NC contacts remain closed until the actuator is pressed. Therefore, if the switch is damaged, destroyed or assembled incorrectly, the contacts remain closed. On the A02ES-H, if the operator or switch block become separated, the circuit will open.

ELECTRICAL SPECIFICATIONS

- Electrical function : push to shut off, pull or twist to release
- Current/voltage rating - NC contacts :
AC-12, 3A 250VAC
AC-15, 1,5A 250VAC
DC-12, 2A 30V
DC-13, 1A 30V
- Current/voltage rating - NO contacts :
AC12, 0,6A 250VAC
AC14, 0,3A 250VAC
DC12, 2A 30V / 1A 30V
- Electrical life : 100.000 cycles
- Insulation resistance : 100 MΩ min.
- Dielectric strength : contact block 2.500 Vrms
- Contacts : gold plated silver

GENERAL SPECIFICATIONS

- Panel thickness : 6 mm (.236) max.
- Low level or mechanical life : 250.000 cycles
- Recommended torque : 2Nm
- Switch terminals : M3 screws

OPERATING FORCE

- Push to shut off : 32N
- Pull to release : 21N
- Turn to release : 0,27Nm
- Minimum force to direct opening action : 80N

ENVIRONMENTAL SPECIFICATIONS

- Front panel sealing : IP65
- Terminals IP20 (finger safe)
- Operating temperature : -25°C to +60°C
- Storage temperature : -45°C to +80°C

AGENCY APPROVALS



UL 508
CSA C22.2 No 14-10



EN 60947-5-5

PANEL CUT-OUT

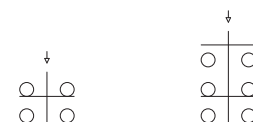
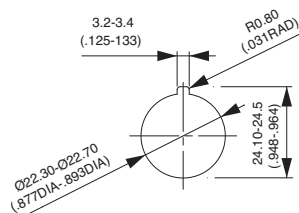

Double pole
Normally closed

Double pole NC
+ single pole NO



Mounting accessories : Standard hardware supplied : 1 nut and 1 flat panel seal



Packaging unit : box of 1 piece with instruction sheet. *Instruction sheet also available on request.*

The company reserves the right to change specifications without notice - Not for sale in JAPAN.

A02ES-H series

High-security emergency stop switches

Panel cut-out \varnothing 22 (.866)

Double pole, normally closed



A02ESH3B102IX0

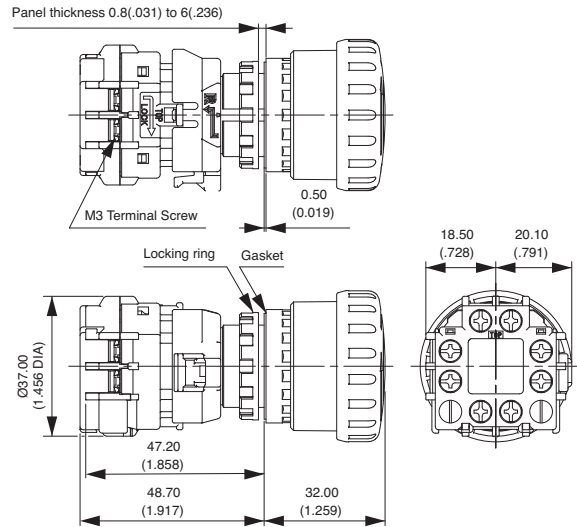

Double pole, normally closed + Single pole, normally open



A02ESH3B112IX0

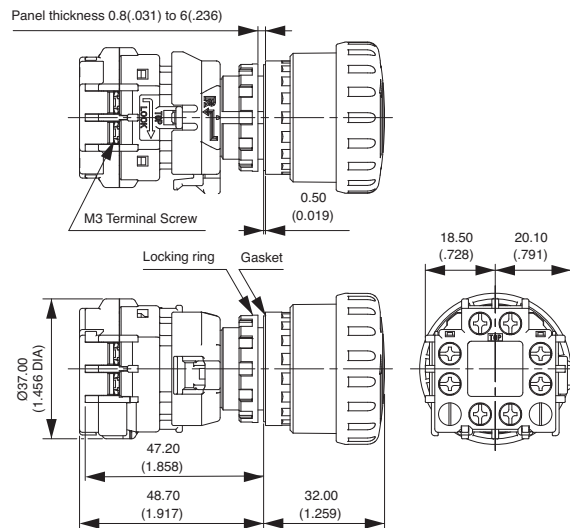

\varnothing 60 mm name plate

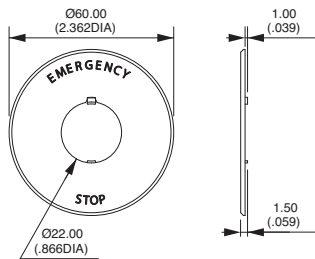

Legend "EMERGENCY STOP" is indicated outside a \varnothing 44 mm circle.

A02-U27Y

Anti-rotation ring

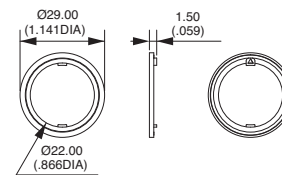

A02-U9ZRL

Locking ring wrench

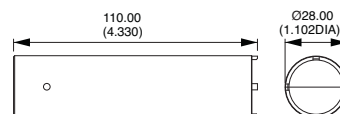

A02-9ZT1