

DETAILS

Product Number	C10892_GT3-M
Family	Gt3
Type	Lens array
Color	clear
Diameter	35 mm
Height	9 mm
Style	round
Optic Material	PMMA
Holder Material	
Fastening	pin, glue
Status	production ready
ROHS Compliant	Yes
Date Updated	10/11/2014



OPTICAL PROPERTIES

LED	Viewing Angle	Light Beam	Efficiency	cd/lm	Connector
XP-E	27 deg	Medium	91 %	2.710	-
XP-G	34 deg	Medium	92 %	1.840	-
XB-D	25 deg	Medium	91 %	2.000	-
LUXEON Rebel	28 deg	Medium	89 %	-	-
LUXEON Rebel ES	32 deg	Medium	86 %	-	-
LUXEON A	32 deg	Medium	-	-	-
NCSxx19A	28 deg	Medium	88 %	-	-
NVSxx19A	34 deg	Medium	88 %	-	-
Oslon SSL 80	28 deg	Medium	92 %	-	-
Oslon SSL 150	26 deg	Medium	86 %	2.480	-
Oslon Square EC	32 deg	Medium	88 %	2.020	-
Z5	28 deg	Medium	-	-	-
Double Dome (GM2BB)	30 deg	Medium	-	-	-

Relative intensity of C10892_GT3-M-XBD

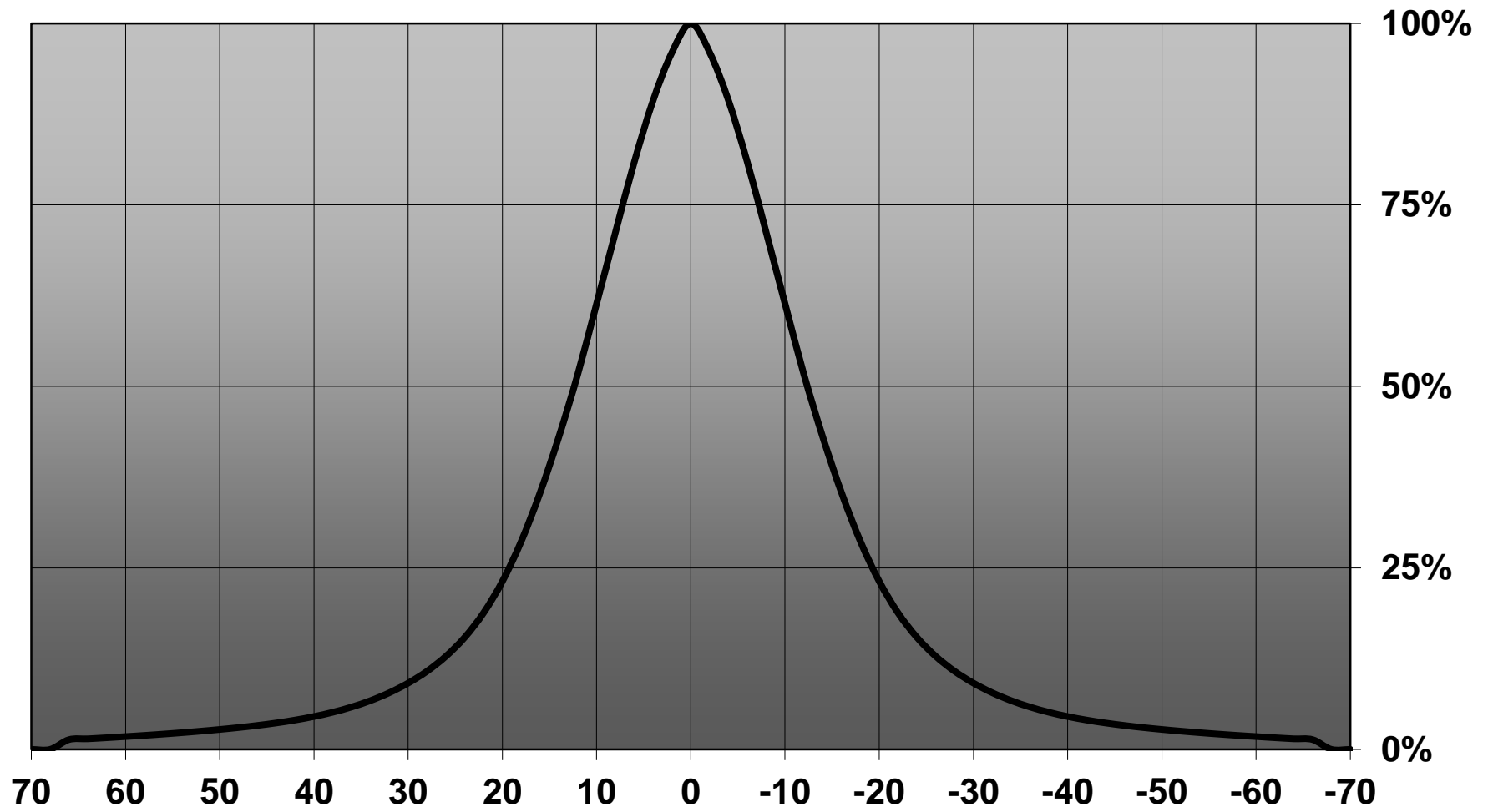

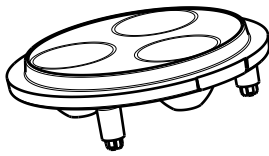

Isometric view
Scale: 1:1

Material: PMMA

Part no.s:

- C10891_GT3-XP-S
- C10891_GT3-XP-G-S
- C10891_GT3-OSL-S
- C10891_GT3-DD-S
- C10891_GT3-RE-ES-M
- C10891_GT3-Z5-S
- C10892_GT3-XP-M
- C10892_GT3-XP-G-M
- C10892_GT3-OSL-M
- C10892_GT3-DD-M
- C10892_GT3-XP-M
- C10892_GT3-Z5-M
- C10893_GT3-XP-W
- C10893_GT3-XP-G-W
- C10893_GT3-OSL-W
- C10893_GT3-DD-W
- C10893_GT3-RE-ES-W
- C11623_GT3-RE-WW
- C11623_GT3-N19-WW
- C11624_GT3-XP-WW
- C11624_GT3-XP-G-WW
- C11624_GT3-OSL-WW
- C11624_GT3-DD-WW
- C11624_GT3-Z5-WW

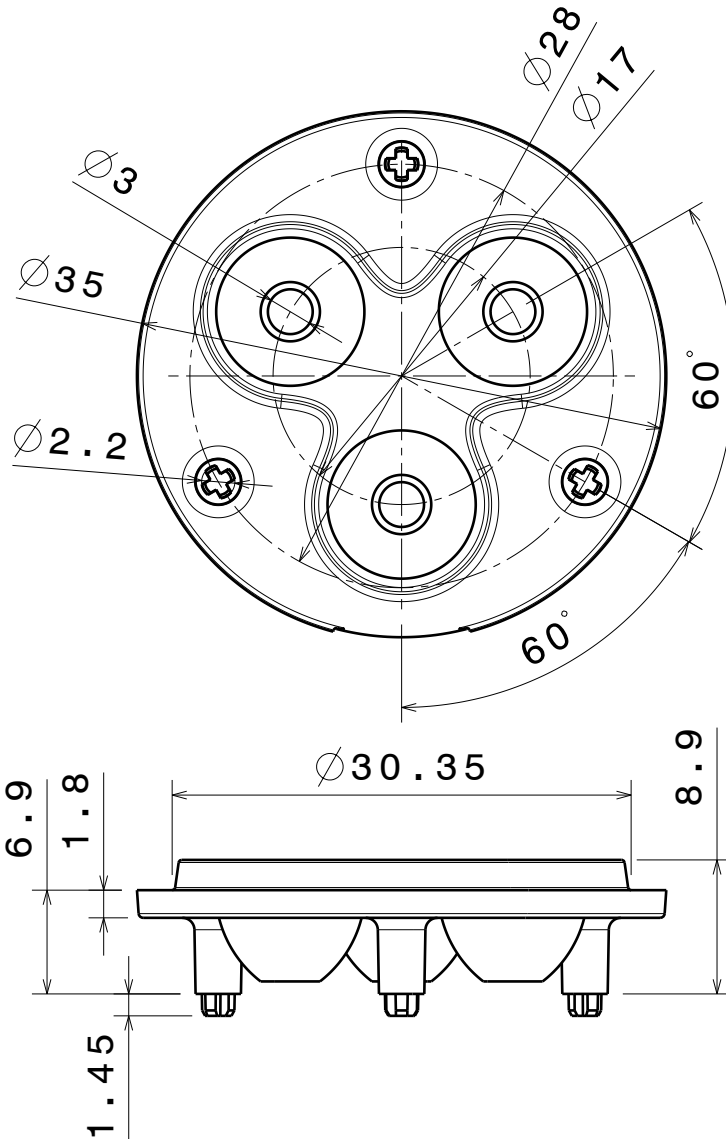

Bottom view

Front view

This drawing is our property.
It can't be reproduced
or communicated without
our written agreement.



L
T
F
F

e
e
i
i
N
n

DRAWING TITLE

Datasheet GT3-Series Lens

DRAWN BY p		DATE 08.01.2010		DRAWING TITLE Datasheet GT3-Series Lens			
CHECKED BY t k		DATE 07.01.2010		SIZE A4	DRAWING NUMBER -		REV 1
DESIGNED BY hh		DATE 07.01.2010		SCALE 2:1	WEIGHT (g)	SHEET 1/1	

Ledil Oy C10892_GT3-XP-G-M C10892_GT3-XP-G-M / LDC (Linear)

Luminaire: Ledil Oy C10892_GT3-XP-G-M C10892_GT3-XP-G-M
Lamps: 3 x Cree XP-G (White)

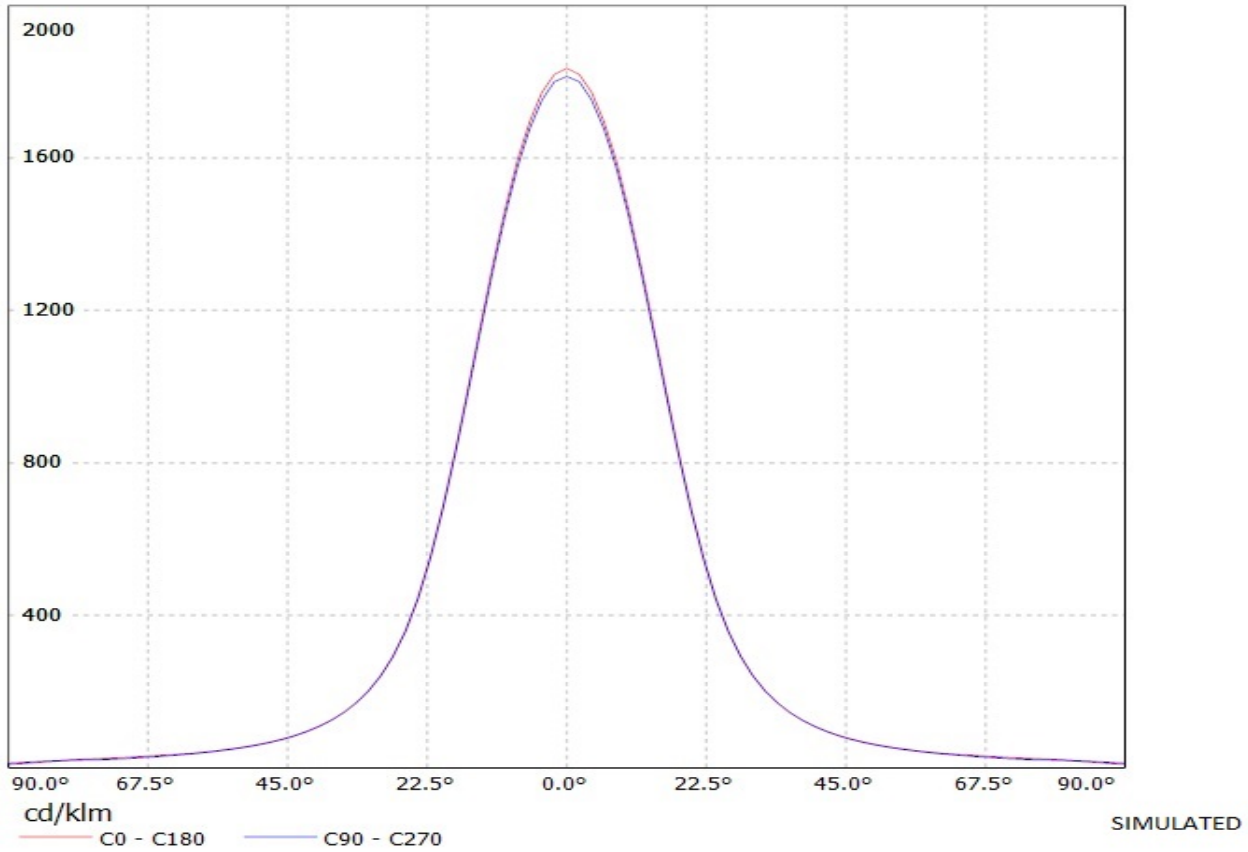

Luminaire: Ledil oy C10892_GT3-M-OSL150 (Osram Oslon 150 deg 266lm @ 250mA)
Lamps: 1 x Osram Oslon 150 deg 266lm @ 250mA

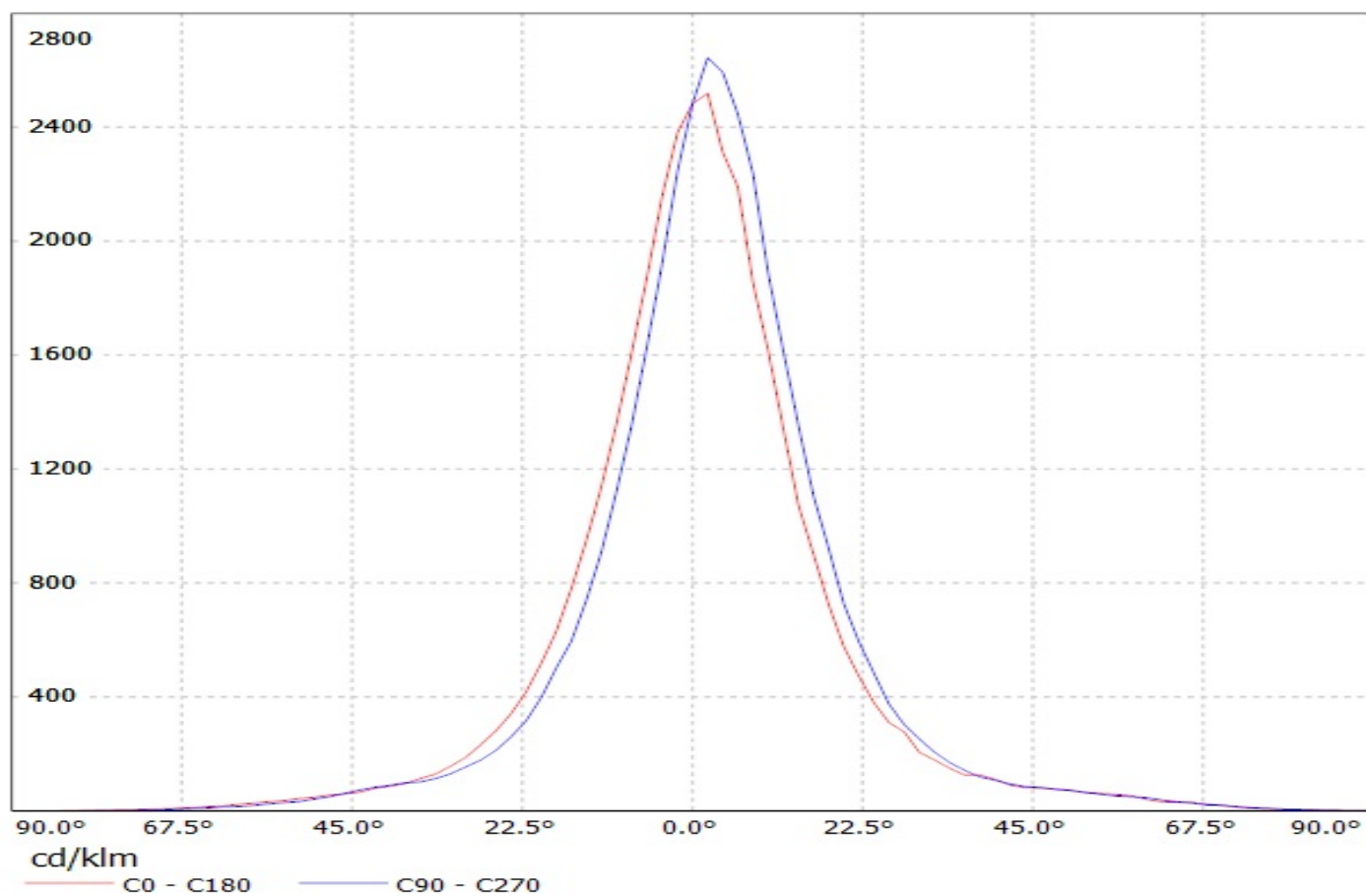

Ledil Oy C10892_GT3-XP-G-M C10892_GT3-XP-G-M / LDC (Polar)

Luminaire: Ledil Oy C10892_GT3-XP-G-M C10892_GT3-XP-G-M

Lamps: 3 x Cree XP-G (White)

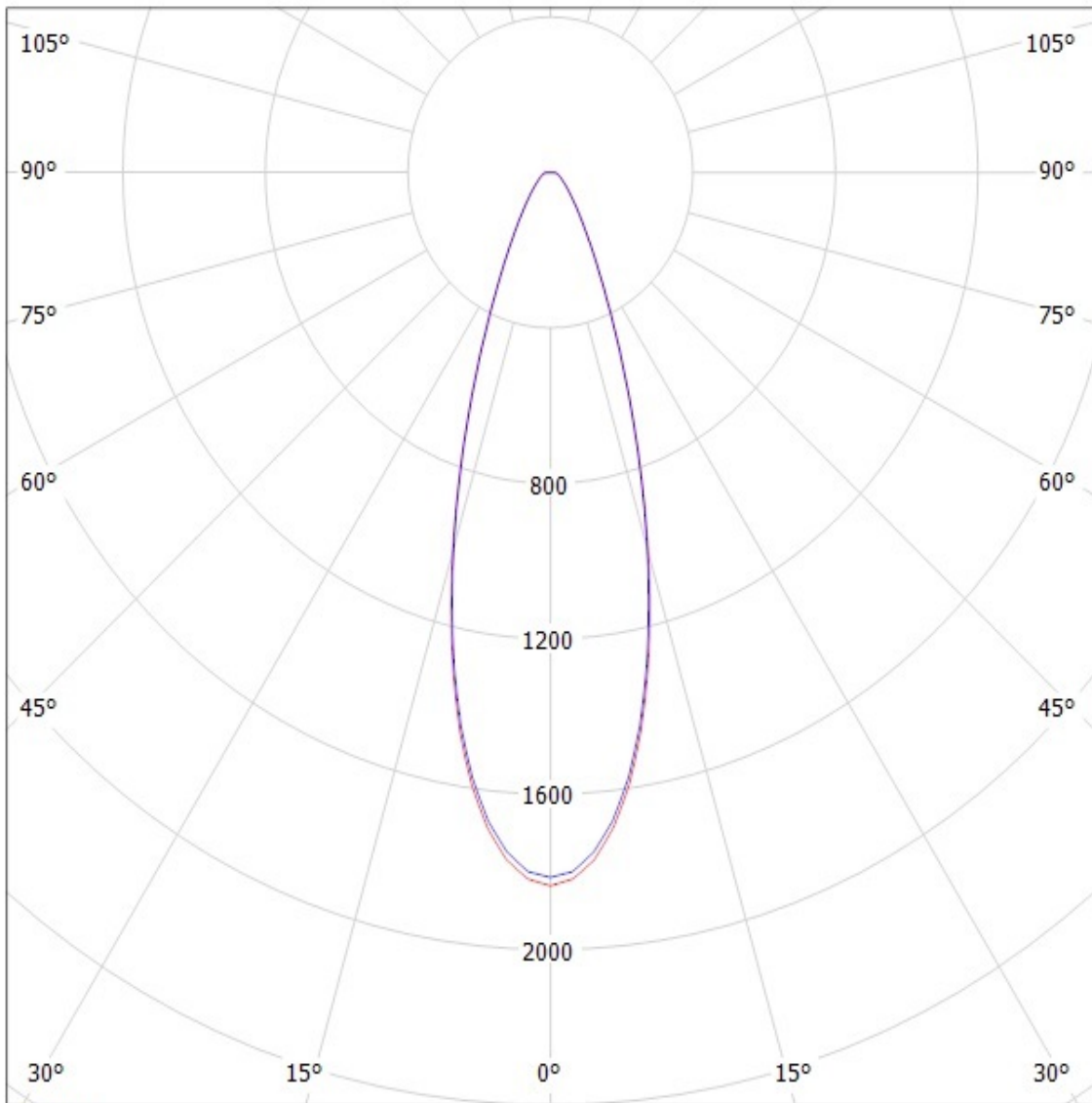

cd/klm

— C0 - C180

— C90 - C270

SIMULATED

Luminaire: Ledil oy C10892_GT3-M-OSL150 (Osram Oslon 150 deg 266lm @ 250mA)
Lamps: 1 x Osram Oslon 150 deg 266lm @ 250mA

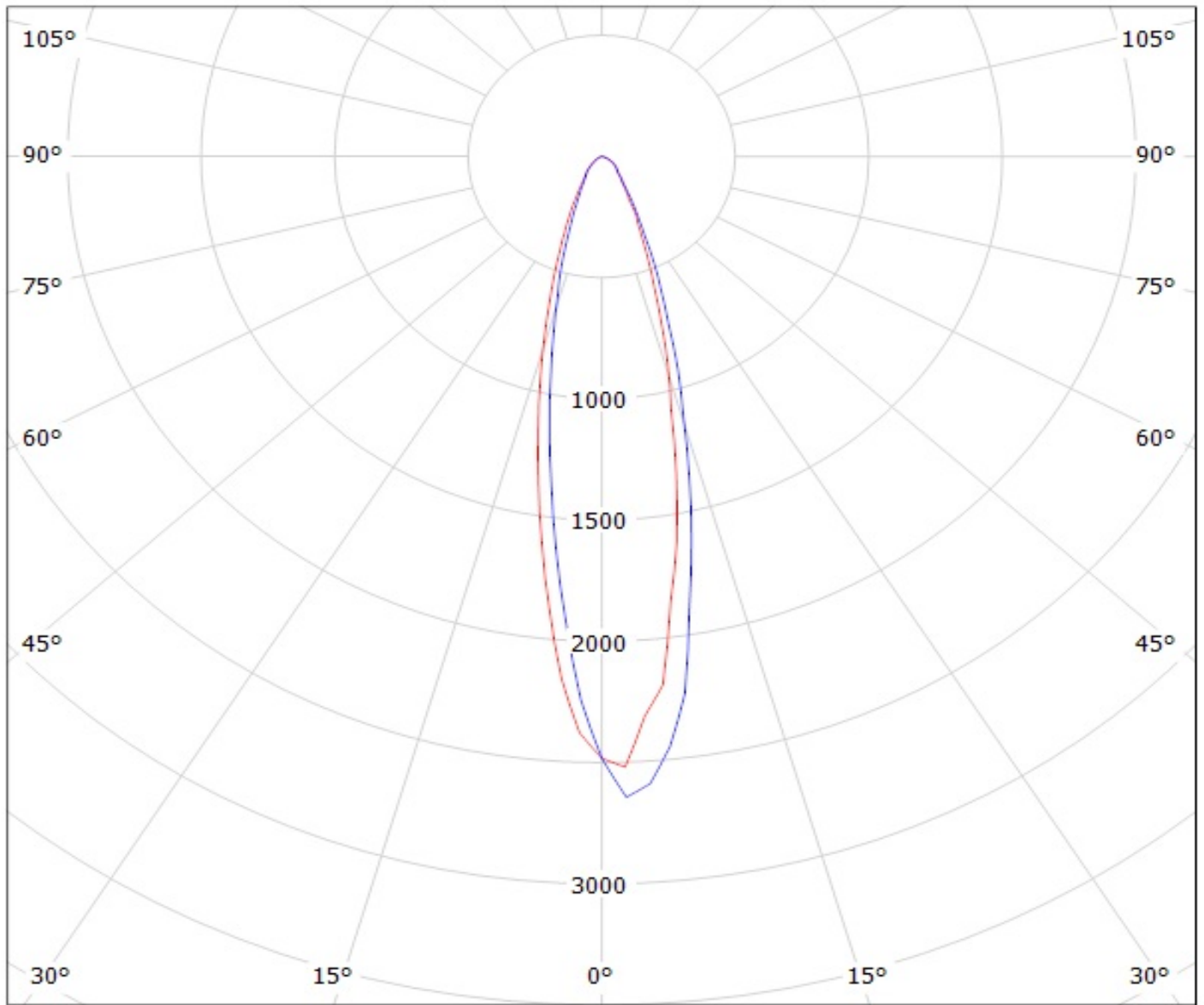

cd/klm

— C0 - C180 — C90 - C270

NOTE: The typical divergence will be changed by different color, chip size and chip position tolerance. The typical total divergence is the full angle measured where the luminous intensity is half of the peak value.